



by Schneider Electric

# Vertical Cable Manager AR7585 Installation

## Inventory

**A**  
20U

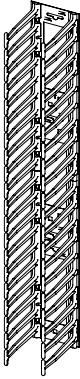

**B**  
23U

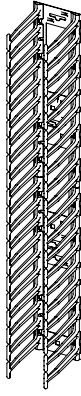

QTY:

1

1

6

1

5

4

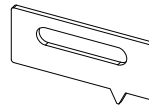
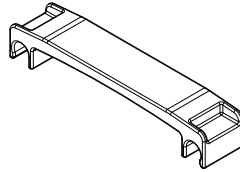

**Adjust the vertical mounting rails and remove all hole covers and plugs**

Note: If installing in rear of enclosure, move or remove vertical O U accessory channel.

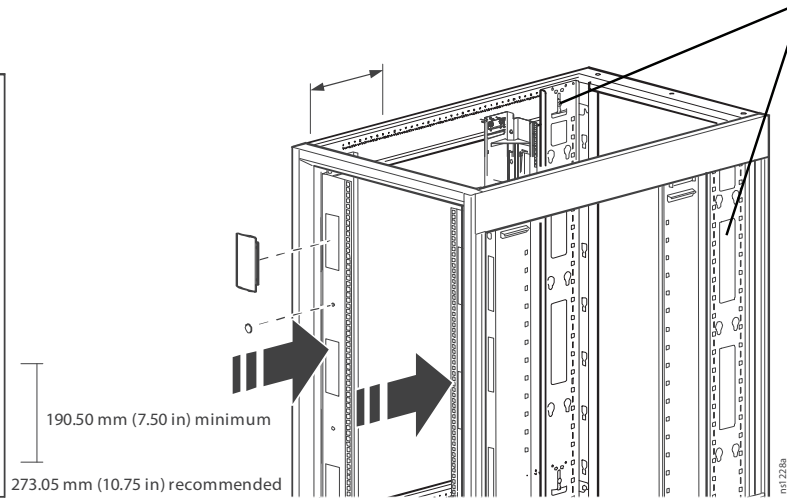
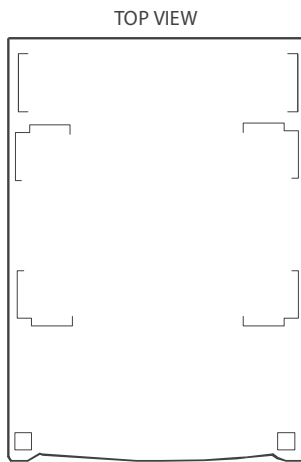

**Identify the mounting slots**

20U

**A1**

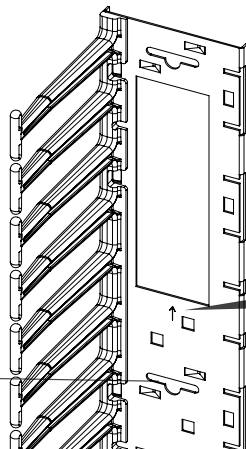

23U

**B1**

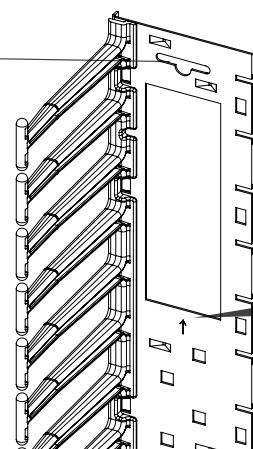

## NetShelter 45 U Installation

1

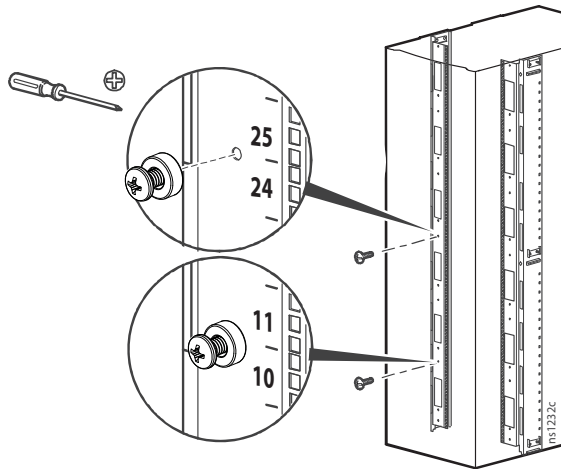

2

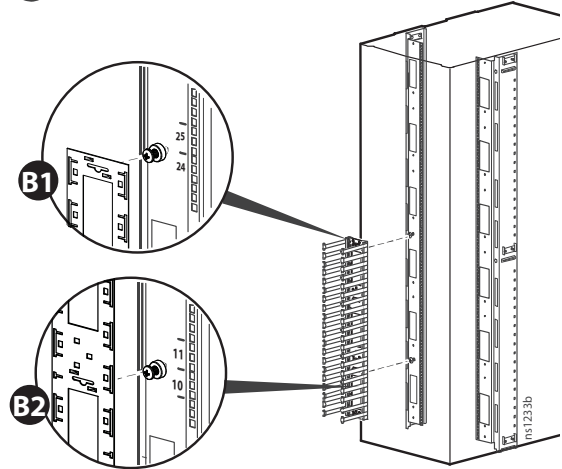

3

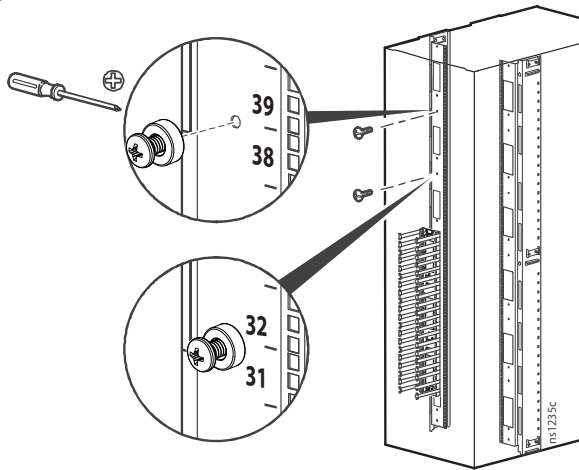

4

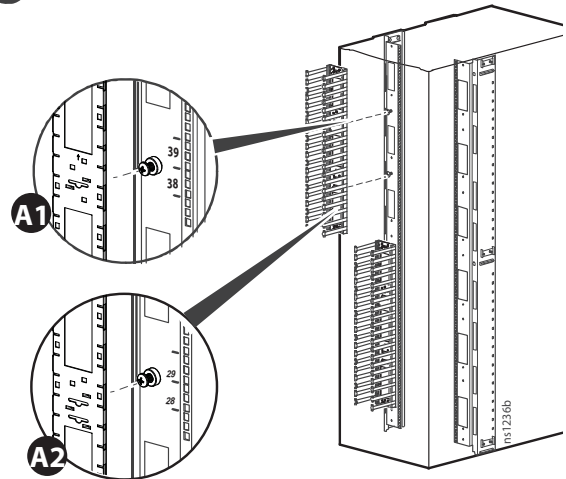

## Vertical Cable Manager—Installation

5

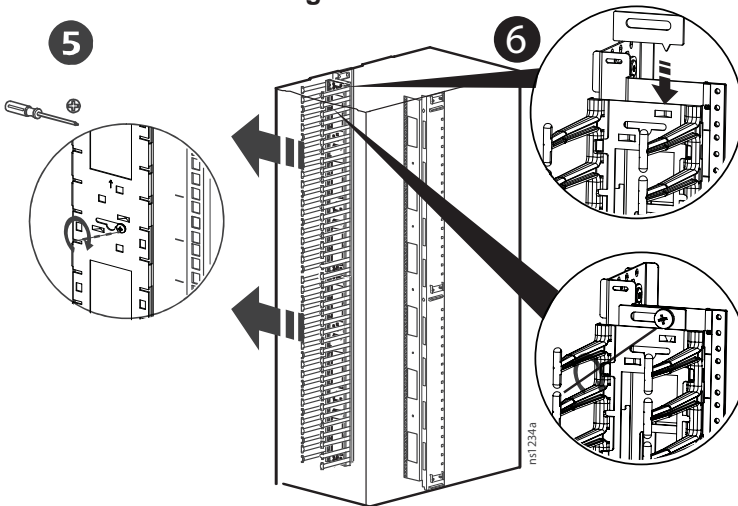

6

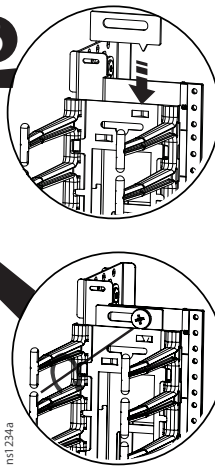

## Attach the cable retainers

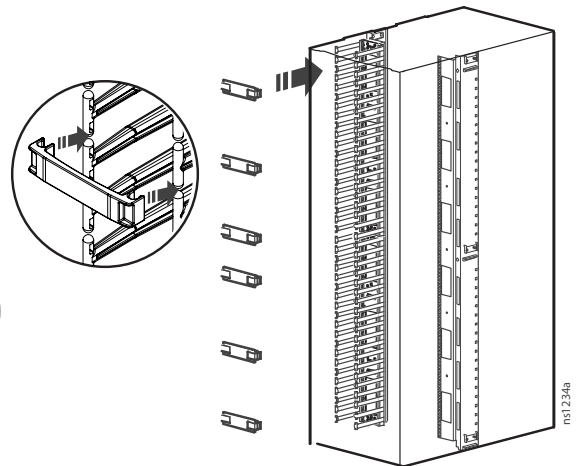

Customer support and warranty information is available at the APC Web site, [www.apc.com](http://www.apc.com).

© 2012 APC by Schneider Electric. APC, the APC logo are owned by Schneider Electric Industries S.A.S.  
All other trademarks are property of their respective owners.

990-5056-001  
11/2012