



26-Port Fast Ethernet PoE Switch, 24 PoE Outputs, 2 x Gigabit RJ45

The LevelOne FGP-2601 series are unmanaged PoE switches with 24 RJ45 PoE ports. The switches are IEEE 802.3af/at compliant, providing power and data over a single Ethernet cable to any PoE device, with a total power budget of 150/250/380/500/630W, or up to 30W per port. Ideal for desktops, they are also 19-inch rack-mountable, which provides convenient and flexible installation. The FGP-2601 switches are designed for small-to-medium businesses that require an affordable solution for deploying PoE infrastructure.

Key Features

- IEEE 802.3af/at PoE compliant to simplify deployment and installation
- Power protection: OVP/OCP/OTP
- IEEE 802.3x Flow Control protects against lost packets for reliable data transmission
- PoE on/off control per port by dip switches
- 19-inch metal housing

Specifications

System Specifications

Standards & Protocols:

IEEE 802.3 10-BASE-T (Ethernet)
IEEE 802.3u 100-BASE-TX (Fast Ethernet)
IEEE 802.3ab 1000BASE-T (Gigabit Ethernet)
IEEE 802.3x Flow Control (full-duplex flow control)
IEEE 802.3af Power over Ethernet
IEEE 802.3at Power over Ethernet Plus

Memory:

MX25L4005AMC-12G

Buffer Memory:

512Kbit

Port:

24 x 10/100Base-TX RJ-45 PoE Ports
2 x 10/100/1000Base-T RJ-45 Ports

Button/Knob:

POWER Button

**Indicator:**

Power, Uplink, LAN 1~24 port, PoE 1~24 port

Transmission Method:

10Base T Cat. 3, 4, 5 UTP/STP
100Base TX Cat. 5 UTP/STP
1000Base TX Cat. 5e/6/7 UTP/STP

Power Input:

AC Power input(100V~240V), 50-60 Hz

Power Output:

Per Port 56VDC, Max. 30 watts (802.3at)

Power Consumption:

150W/250W/380W/500W/630W

Backplane (Gbps):

8.8Gbps

MAC Address Table:

4K

Data Transfer Rate:

10/100/1000Mbps

Features

PoE:

IEEE 802.3at/af Power over Ethernet/PSE Mode B

Performance

Packet Forwarding Rate:

10Mbps 14880pps,
100Mbps 148800pps,
1000Mbps 1488000pps

Jumbo Frame (K):

10k

Switching Capacity:

8.8Gbps

Environment

Temperature (°C):

Operating: 0° ~ 50°C
Storage: -20 to 70 °C

Humidity (Non-condensing):

Storage: 10% ~ 90%
Operating: 10% ~ 90%

Installation:

Rackmount

Physical Specifications

Dimensions (W x D x H mm):

480x118x44

Weight (g):

2.5kg

Reliability

MTBF:

50khours (5 years)

Approval and Compliance

EMI/EMS:

EMI:

EN55032:2012+AC:2013

EN55022:2010+AC:2011

AS/NZS CISPR 22 Amdt. (2010)

EN61000-3-2:2014

EN61000-3-3:2013

EMS:

EN55024:2010

IEC61000-4-2:2008

IEC61000-4-3:2006+A1:2007+A2:2010

IEC61000-4-4:2012

IEC61000-4-5:2005

IEC61000-4-6:2013

IEC61000-4-8:2009

IEC61000-4-11:2004

Safety:

FCC Class A, CE

Diagram

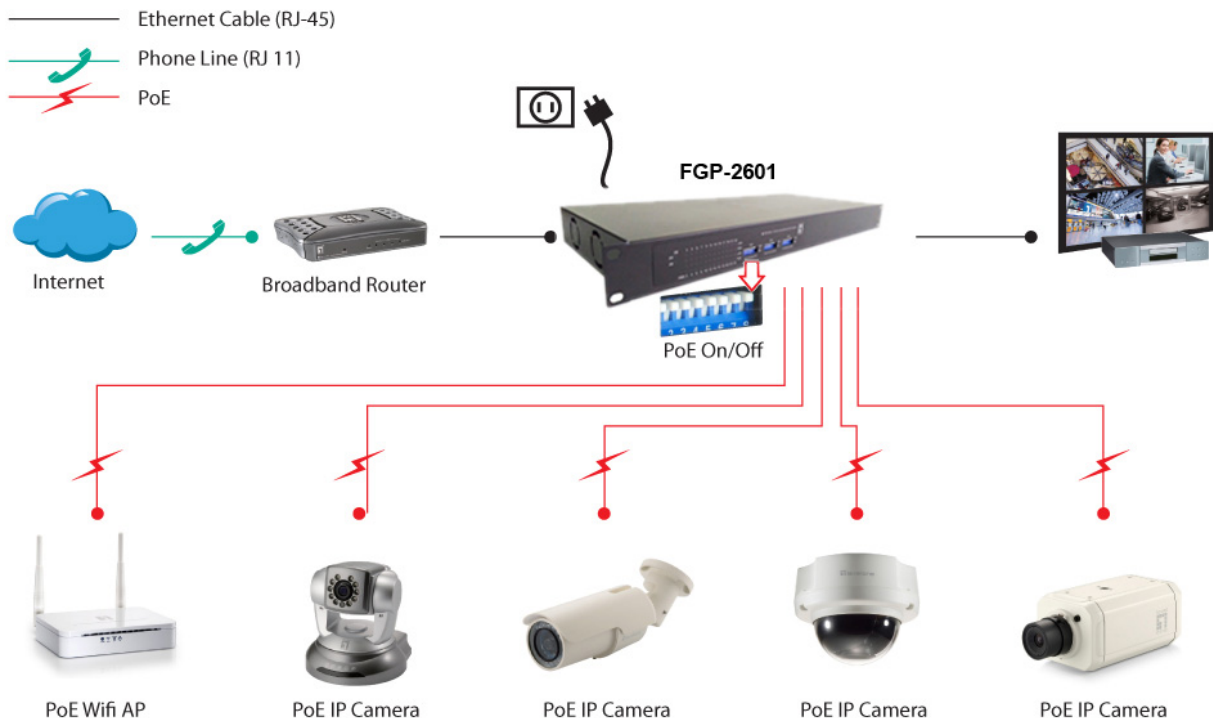

Order Information

FGP-2601W150: 150W

FGP-2601W250: 250W

FGP-2601W380: 380W

FGP-2601W500: 500W

FGP-2601W630: 630W

www.level1.com



Package Contents

FGP-2601W150

Power Cord

User Manual

No liability or responsibility for any errors or omissions in the content.
Specifications are subject to change without notice.
All mentioned brand names are registered trademarks and property of their owners.
Copyright © Digital Data Communications GmbH, Germany. All Rights Reserved.