

# Deep Silence 6 Rev. B

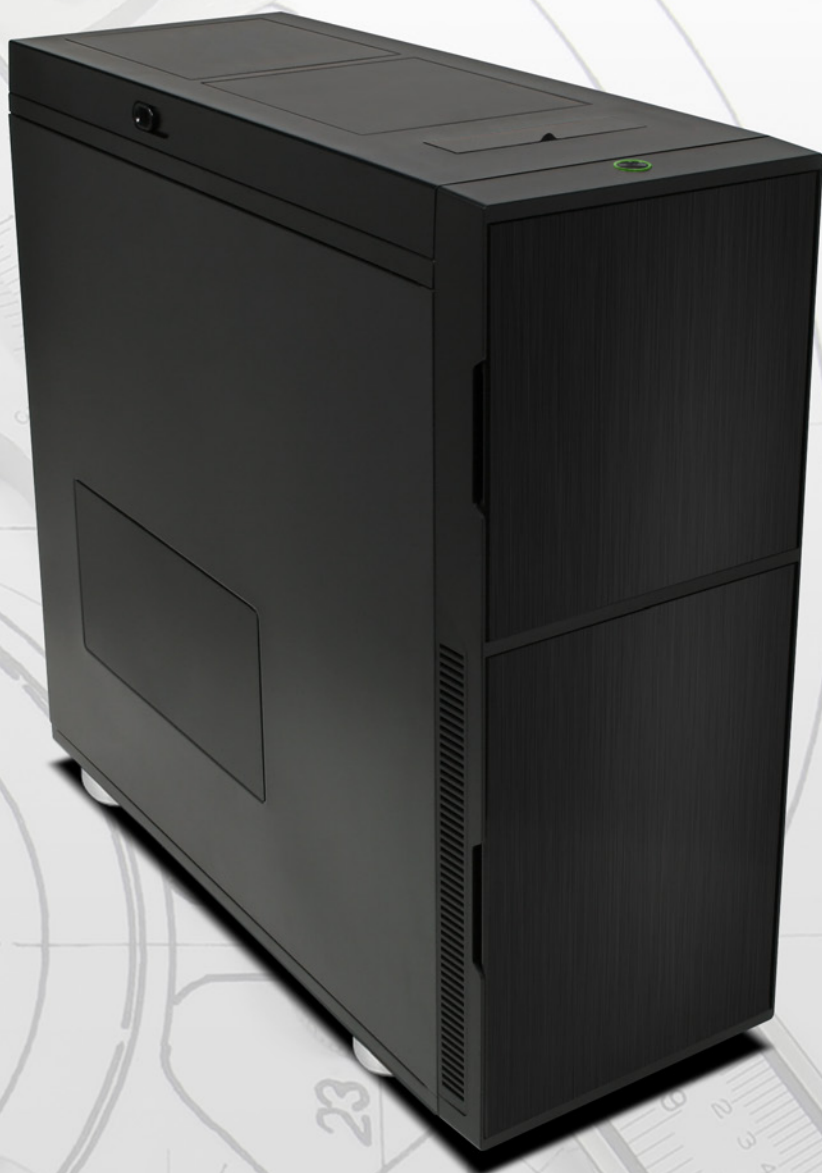

<b>I. Introduction</b>	<b>02</b>
• Specifications	02
• Accessories	03
• Features	03
<b>II. Installation Instructions</b>	<b>07</b>
1. Installation of the motherboard	07
2. Installation of external drives	08
2.1 Optical drives	08
2.2 Utilizing the external 3.5 inch bay	09
3. Installation options of HDD's	09
3.1 Mounting of hard disk drives	09
3.2 Utilizing the additional 3-bay HDD-cage	10
3.3 Utilizing the 6 x 2.5 inch mounting frame	10
4. Removing the front panel and top cover	11
4.1 Removing the front panel	11
4.2 Removing the top cover	11
5. Fan assembly	12
5.1 Fans in the front	12
5.2 Fans under the top cover	13
5.3 Fans in the mounting bracket behind the HDD-cage	13
5.4 Fans in the side panel	14
5.5 Fans on the bottom of the case	14
6. The 2-channel fan control	15
6.1 Connecting the fans to the fan control	15
6.2 Operation of the fan control	16
7. The Active Air Chimney	16
7.1 Connecting the fans to the Active Air Chimney	16
7.2 Operation of the Active Air Chimney	17
8. Installation of a water cooling	17
8.1 Installation of a radiator or compact water cooling on the mounting bracket behind the HDD-cage	17
8.2 Installation of a radiator or compact water cooling under the top cover	18
9. The I/O-Panel	19
<b>III. Support</b>	<b>20</b>

## I. Introduction

Congratulations on the purchase of your new Nanoxia Deep Silence 6 Revision B. We are confident that you will be delighted by your new PC case for many years to come.

The Nanoxia Deep Silence series has already won more than 100 awards from the international trade press. The innovative design and the exceptional quality certainly delight experts and enthusiasts alike.

Based on the suggestions of our customers, our design team has developed meaningful optimizations in the context of product development, which you will find in the present revision. For example, our designers have created a novel 6 x 2.5 inch mounting frame, which allows the space saving and decoupled mounting of up to six 2.5 inch drives.

The Deep Silence 6 Tower in the new revision is again a true case giant and can accommodate the most demanding projects. Whether you are planning a particularly smooth-running high-end gaming system with extensive water cooling or are looking for an enclosure that can be used perfectly as a data storage server with multiple hard drives - the Deep Silence 6 Rev. B is perfect for you.

The enormous space that the case offers allows the installation of a 280/360 mm radiator under the top cover, as well as a 240/280 mm radiator in the specially designed mounting frame on the HDD cage. Many unique features like the Active Air Chimney and the redesigned I/O panel have been integrated into the chassis to maintain the clean look of the case.

### Specifications

<b>Dimensions:</b>	644 x 250 x 655 mm (Height x Width x Depth)
<b>Material:</b>	Steel, plastics
<b>External drive bays:</b>	2 x 5.25 inch (tool-free) 2 x 5.25 inch /w 3.5 inch adapter (tool-free)
<b>Internal drive bays:</b>	10 x 2.5/3.5 inch bays (max. 13) 6 x 2.5 inch

## Accessories

Rubber sealings for tube holes



EPS 4 + 4-Pin extension



24-Pin ATX extension



Fan screws



Stand-offs for mainboard



Screws for mainboard mounting



Screws for HDD mounting



Screws for 3.5" mounting frame



Mounting screws for 2.5"HDD/SSD



Mounting screws for 2.5"HDD/SSD (long)



Mounting screws for PSU



Thumbscrews



If you are missing any of the items listed above, please contact our customer service immediately:  
[support@nanoxia-world.com](mailto:support@nanoxia-world.com)

## Features:

- **Water Cooling ready**
- **Special, lateral fastening points** for a 120/140/240/280/360 mm radiator under the top cover
- **Mounting Bracket** for a 120/140/240/280 mm water cooling radiator or up to two 120/140 mm fans behind the HDD cage
- **Complete customizable soundproofing** with high quality materials meeting industrial standards
- **Active Air Chimney**
- **6 x 2.5 inch mounting frame**
- **Tool-free mounting of optical drives**
- **4 x USB 3.0, 2 x USB 2.0**
- **10 Slots** for expansion cards
- **Max. VGA length: 405 mm** (up to 435 mm without the Mounting Bracket)
- Room for **CPU coolers** with a maximum height of up to 200 mm
- **Mounting hole** for CPU cooler in the motherboard tray
- **Cable management** with 15 rubberized holes in the motherboard tray
- **Stepless 2-channel fan control** for up to 8 fans

## Noise Insulation

The Nanoxia Deep Silence 6 Rev. B has been developed with the aim of offer the buyer a low-noise case, while at the same time allow for extremely low system temperatures.

The noise insulation concept is based on multiple interacting design elements:

The most important part is the large scale lining of the case with sound-absorbing insulation materials. These materials are manufactured specifically to meet the requirements of the developers of the Nanoxia Deep Silence case series and act equally against airborne sound and structure-borne noise.

Included are special rubber seals which can be used to alternatively close the tube holes next to the PCI slot covers and above the rear chassis fan, in case you should not need them.

The Active Air Chimney also helps to minimise noise. In terms of a low operating noise of your system, the Air Chimney can be closed if required - the pre-installed fans under the chimney are thereby automatically switched off.

Another design element for optimum sound insulation is the use of two sound-insulated front doors. The doors are equipped with sound-absorbing foam. Hard drives and power supply are also decoupled mounted.

The whole concept of sound proofing concept meets the highest expectations.

## Ventilation System

The Deep Silence Nanoxia 6 Rev. B has an integrated ventilation system consisting of five 140 mm Deep Silence fans and a built-in 2-channel fan controller for up to eight case fans. A total of up to twelve fans can be mounted.

The Deep Silence axial flow fans have been specifically optimized for very quiet operation. The range of fan speeds and controls was designed to enable each user to adjust the case ventilation to their own needs.

All air intake openings (front, bottom, left side panel) are readily accessible and have easy to clean dust filters. Behind the lower front door you can find two „Easy Access“ fan trays, allowing an easy access to both the dust filter and the front 120 mm fan(s).

All air intake openings (front, bottom, left side panel) are readily accessible and have easy to clean dust filters. Behind the lower front door are two “Easy Access Panels” located, allowing an easy access to both the dust filter and the front 140 mm fans.



The innovative Nanoxia Active Air Chimney makes it easy to adapt the case to your needs. Under extreme conditions you can counteract heat generation under the top cover effectively:

The two pre-installed fans under the cover will be automatically enabled if the chimney is opened. Thus the warm air is dissipated quickly and effectively from the case. When the air chimney is closed, the fans will be switched off again. A groove in the bearing surface of the Air Chimney serves as additional protection against ingress of liquids.

## Standard Equipment:

<b>Front:</b>	2 x 140 mm Nanoxia Deep Silence fans (max. 1,100 rpm)
<b>Top cover:</b>	2 x 140 mm Nanoxia Deep Silence fans (max. 1,400 rpm)
<b>Rear:</b>	1 x 140 mm Nanoxia Deep Silence fans (max. 1,100 rpm)

## Optional Equipment:

<b>Top cover:</b>	max. 3 x 120/140 mm (2 x pre-installed)
<b>Side:</b>	2 x 120/140 mm fans
<b>Bottom:</b>	2 x 120 mm or 1 x 140 mm fans (removal of HDD-holder necessary)
<b>Mounting Bracket on the HDD-cage:</b>	2 x 120/140 mm fans

## Watercooling-ready

The Nanoxia Deep Silence 6 Rev. B has been prepared perfectly for the installation of a high-end water cooling system.

Therefore you can install radiators or a compact water cooling solution under the top cover as well as on the specially designed mounting bracket attached to the hard drive cage:

**Top cover:** 120/140/240/280/360 mm radiator

The case cover has special, lateral fastening points which allow for installation of a 120/140/240/280/360 mm radiator. Please note that - depending on the manufacturer - under certain circumstances the overhead 5.25 inch drive bay may no longer be used when using a 360 mm radiator.

**Mounting Bracket on the HDD cage:** 120/140/240/280 mm radiator

The mounting bracket between motherboard and hard drive cage is designed to make optimal use of the enormous size of the Nanoxia Deep Silence 6 Rev. B for water cooling systems.

The bracket can be used to install a 120/40/240/280 mm radiator. If necessary, the radiator can then even be equipped with fans on both sides. Due to the generous proportions of the case, spacing problems are of no concern.

**If you want to mount a compact water cooling system on the mounting bracket, you should check before the installation whether the factory hoses between cooler and radiator are of sufficient length.**

## Rubber hose guides:

The Deep Silence 6 Rev. B offers four rubber hose guides, so that the appropriate water cooling components can be operated or mounted externally.

## Active Air Chimney

One of the main features of the Nanoxia Deep Silence 6 Rev. B is without a doubt the Active Air Chimney. The Air Chimney can easily be opened or closed using the slider on the side of the top cover and fulfils various functions.

When open, the Active Air Chimney supports the case ventilation „active“. Once the Air Chimney is opened, the pre-assembled fans under the top cover are switched on automatically. Thus, the heated air is removed rapidly and effectively from the case interior; a very handy feature – especially in „heated“ situations.

For the best noise insulation the pre-installed fans under the top cover are switched off when the Air Chimney is closed.

When closed, the uniform design line of the case is always maintained. If for example liquid should be spilled on the cover, it would not directly pass through into the interior of the enclosure – as often encountered in the honeycomb design cases.

A further advantage of the Air Chimney is the ability to retrofit the case with a radiator or compact water cooling solution.

**On the next pages you can find some useful tips and explanations for the optimal use of your new case and for the installation of your hardware.**

## II. Installation Instructions

### 1. Installing the Motherboard

You can mount HTPX, E-ATX, XL-ATX, ATX, M-ATX and Mini-ITX motherboards in the Deep Silence 6 Rev. B. In order to ensure an easy installation of your motherboard, we suggest the following procedure:

Please consult the following charts to find your motherboard form factor:

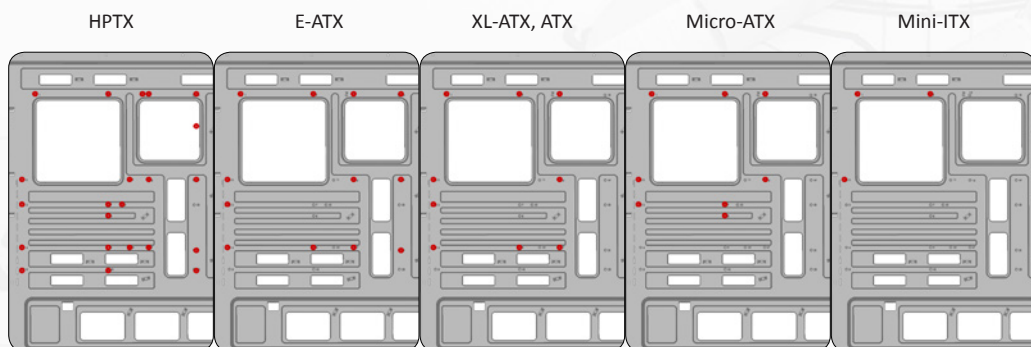

Attach the stand-offs according to your motherboard form factor



Attach the included EPS extension cable on to your motherboard – **do not connect it to the power supply yet.**





Next you should mount the CPU cooler - for very large CPU coolers, the attachment of the EPS extension cable after installation can be difficult.

Now place the motherboard gently inside the case and lead the EPS extension cable through the opening provided in the top left of the motherboard tray.

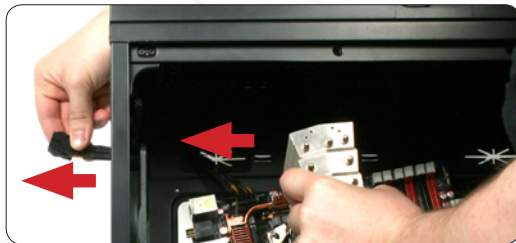

Fix the motherboard to the motherboard tray. After the installation of the power supply, you can connect the EPS extension cable to the EPS-connector on the PSU at the back of the motherboard-tray.

## 2. Installation of external drives

You can install up to four external drives in the Deep Silence 6 Rev. B; two adapter frames for mounting 3.5 inch drives are included.

### 2.1 Optical drives

To install the optical drives, please remove both side panels. The installation of optical drives is tool-free.

Remove the 5.25 inch cover by pulling the lateral tilting lever cautiously towards you and take out the cover.

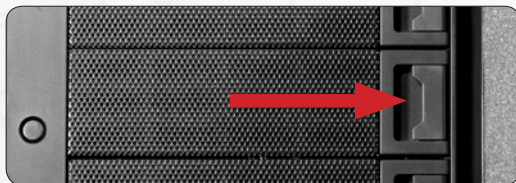

Then loosen the lock on both sides by dragging the black slider backwards (1).

Then slide the drive into the desired position.

Lock the holder by pushing the slider back to its original position (2)

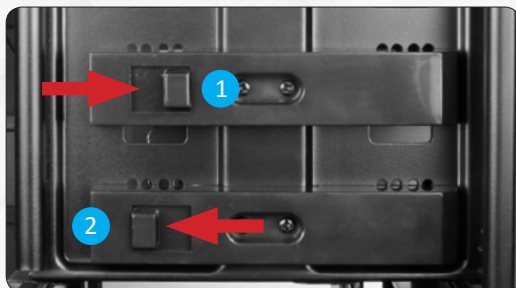

## 2.2 Utilizing the external 3.5 inch bay

If you for example desire to place a 3.5 inch card reader, you can use one of the two internal adaptors for this purpose. Please remove the 5.25 inch cover first.

Open the two quick release of the 5.25 inch bay and remove the mounting frame. Then attach the card reader in the frame, as shown below.

Then place the frame with the card reader back into the slot and lock the quick release. Finally, attach the included 3.5 inch front panel carefully on top of the card reader.

## 3. Installation options for hard drives

The Deep Silence 6 Rev. B allows you the decoupled mounting of 16 hard disk drives. A total of 13 x 3.5 inch bays are available. Included is the newly developed 6 x 2.5 inch mounting frame, which will take three 3.5 inch bays for installation. By using the two 5.25 inch to 3.5 adaptors, you can mount a total of 18 hard disks drives in your case.

### 3.1 Mounting of hard drives

Install the 2.5 or 3.5 inch hard drives in the illustrated mounting frames. In order to extract the frame, squeeze the protruding brackets and pull the slide out gently.

To install a hard drive into a bracket insert the disk so that the connectors point to the back and attach the hard drive using the screws provided.

For the fitting of 3.5 inch hard drives please use the holes in Figure 3A (marked red)

For the fitting of 2.5 inch hard drives please use the holes in Figure 3B (marked red).

**Figure 3A**



**Figure 3B**



**The hard drives slides offer a second pair of mounting holes, so it is possible to shift the position of the drives. Those are marked in blue on the picture.**

To lock the drive, push the bracket with the drive back installed back into the slot until the bracket is re-engaged.

## 3.2 Utilizing the 6 x 2.5 inch mounting frame

Our newly developed 6 x 2.5 inch frame allows the space-saving mounting of up to six 2.5 inch drives. For installation, the mounting frame will need three 3.5 inch bays.

To mount the hard disks, please remove the mounting frame. Insert your 2.5 inch drives vertically in the frame and secure them on both sides with the 2.5 inch mounting screws (long). Then push the frame with the hard drives into the HDD cage in the position you prefer.



If you plan to put the frame in the additional 3-bay HDD-cage, we recommend connecting the SATA power and data cables, before pushing the mounting frame back into the cage and then guide the cables through the appropriate cable guides in the motherboard tray. We recommend using SATA data and power cables with straight connectors.

**If you do not want to use this unique feature, sufficiently 3.5 inch mounting carriers are included to install up to 13 hard disks.**

## 3.3 Utilizing the additional 3-bay HDD-cage

The Deep Silence 6 Rev. B is equipped with an additional 3-bay HDD-cage, which is screwed to the bottom of the case.

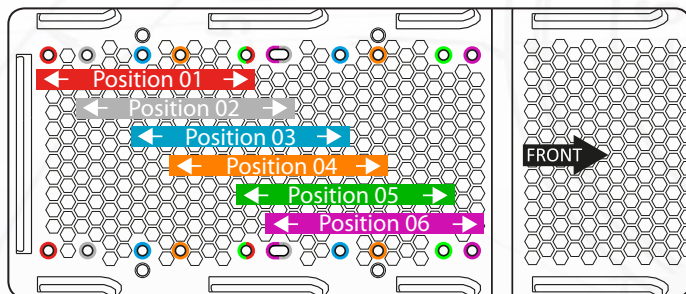

The HDD cage can easily be moved to another position if necessary. To do this, please first remove the four screws that hold the cage on the bottom. Please refer to the drawing for the different mounting points of the cage.

## 4. Removing the front panel and top cover

**Please note that you should always remove the front cover first before you remove the top cover.**

### 4.1 Removing the front panel

To remove the front panel, simply hold the cut-out at the bottom of the front panel and pull it towards you with a firm tug.



### 4.2 Removing the top cover

To remove the lid of the case, hold the recess provided at the rear of the case and pull it upwards with a firm tug.



**When you remove the top cover, proceed cautiously in order to not damage the cables of the I/O-Panel and the Active Air Chimney.**

**To remove the cover completely, you need to remove the right side panel and disconnect the cable to the board that goes to the switch of the Active Air Chimney (see drawing).**

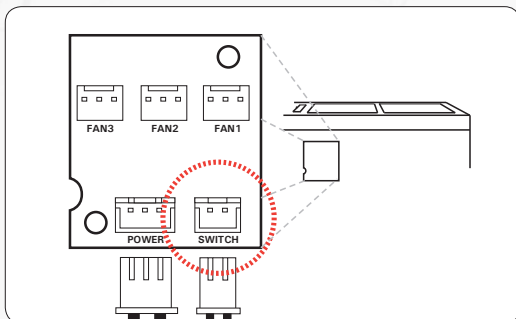



## 5. Fan assembly

Five 140 mm fans are pre-installed in your new case. You can mount up to twelve fans in total.

We recommend the use of the 120 or 140 mm Nanoxia Deep Silence fans, available separately. These are technically and visually equivalent to the factory-installed case fans and will work in perfect harmony with the built-in fan control of your case.

You can, of course, connect the additional fans to the fan controller (**see Chapter 6**) or, where applicable, to the Active Air Chimney (**see chapter 7**).

**All air intake openings of the Deep Silence 6 Rev. B are equipped with easy to clean dust filters. We recommend that you clean them on a regular basis.**

### 5.1 Front Fans

To switch the fans in the front or to clean the dust filters, first open the lower front door. Next, open the “Easy Access Panel” by pushing slightly on the left side of the panel (**diagram 5A**).

You can remove the fan by pushing away the retaining lugs a little bit from the fan and then pull the fan out (**diagram 5B**).

The dust filters can easily be pulled out, as you can see here (**diagram 5C**).

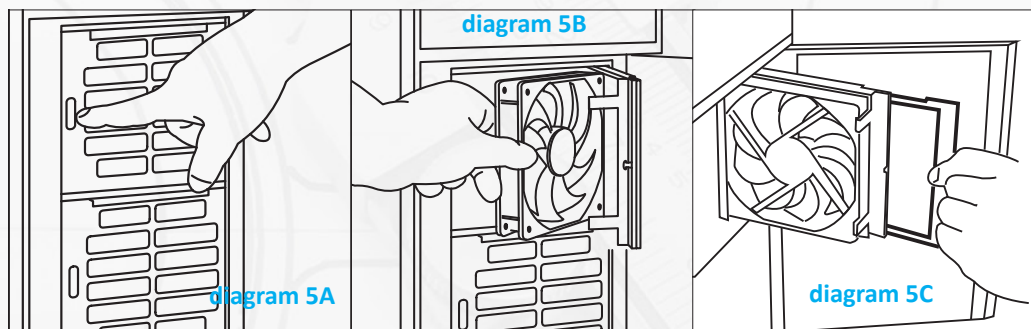

**Please note, that the filter elements must be fully inserted to guarantee the proper operation of the “Easy Access Panel”.**



## 5.2 Fans in the top cover

Two 140 mm fans are pre-installed under the top cover. If required, a total of three 120 or 140 mm fans can be mounted. If you want to install more fans at the top of the case, please remove the plastic cover first (see chapter 4.2). Then hold the fans from the inside and secure it to the top by fastening the screws from the outside.

If necessary, up to three fans can be connected to the Active Air Chimney (see chapter 7.2).

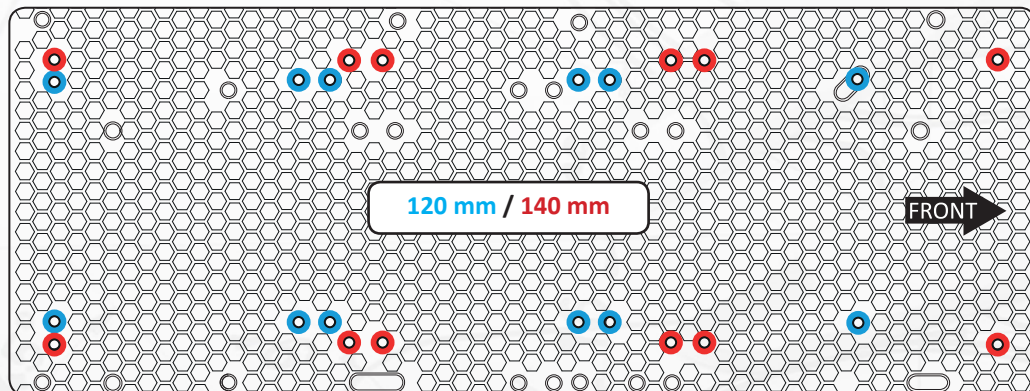

Case fans installed at the top of the case should exhaust air out of the case (fan rear side facing outwards).

## 5.3 Fans in the mounting bracket behind the HDD cage

If you want to mount additional fans inside the case, for example to optimize disk ventilation, you can use the specially developed mounting bracket that is screwed to the hard drive cage. For this, first remove the screws and then take the bracket out.



The bracket offers mounting holes both for 120 and 140 mm fans; install the fans, then attach the bracket with the four screws back to the HDD-cage, as can be seen in the picture.

**If you install case fans in the mounting bracket, those should support the movement of air from front to back.**

## 5.4 Fans in the side panel

If you want to accommodate fans in the side panel, remove the outer cover by loosening the screws on the inside.

The dust filters can remain in its position. Please place the fans on the inside of the side panel above the dust filter and screw them in from the outside.

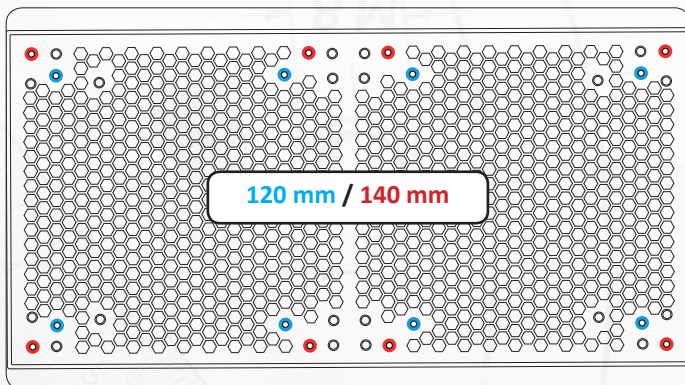

**If you secure the cover in the side panel again after the removal of a side fan, please make sure not to tighten the screws not too much. To avoid damage to the internal thread or the side panel, the screws should be tightened by hand only.**

## 5.5 Fans at the case bottom

You can install two additional 120 or one 140 mm fans on the bottom of the case. It may be necessary to remove the additional 3-bay HDD cage screwed to the bottom (see chapter 3.3)

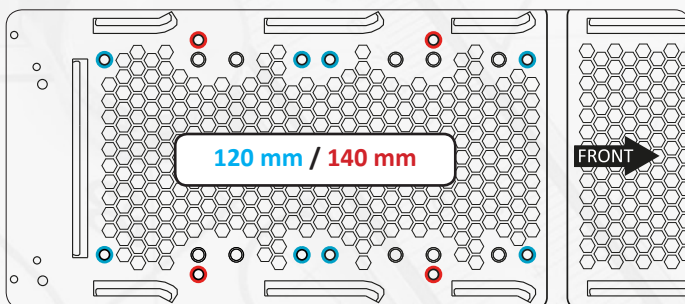

The dust filter at the bottom can be pulled out for easy cleaning.



**If you secure the cover in the side panel again after the removal of a side fan, please make sure not to tighten the screws not too much. To avoid damage to the internal thread or the side panel, the screws should be tightened by hand only.**

## 6. The 2-channel fan controller

Your case is equipped with a stepless 2-channel fan control for up to eight case fans. You can operate up to four fans per channel.

### 6.1 Connecting the fans to the 2-channel fan controller

The fan controller is powered by a 4-pin Molex connector that is connected directly to the power supply.

The controller has two channels (A and B), with each channel able to control up to four 3-pin fans, therefore a total of eight fans can be controlled.

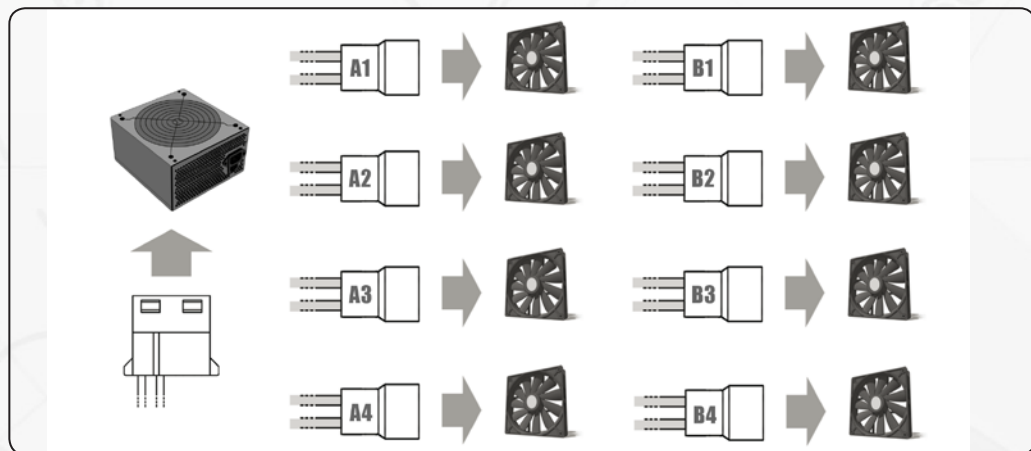

**The fan controller is not designed for the operation of powerful fans. Please take this into account in particular when using fans from other manufacturers. The maximum power per channel must not exceed 18 watts.**

## 6.2 Operation of the 2-channel fan controller

The sliders for controlling the fans controller can be found behind the upper front door. The upper slider controls channel A and the lower slider controls channel B.



## 7. The Active Air Chimney

The innovative Nanoxia Active Air Chimney allows the easy dissipation of hot air in case of a heat buildup under the top cover: Once the Air Chimney is opened, the connected fans are automatically activated. When the Active Air Chimney is closed, the fans are switched off again.

### 7.1 Connecting the fans to the Active Air Chimney

At the back of the motherboard tray, you can find a circuit board to which you can connect up to three fans. It is powered by a 3-pin Molex connector that is connected directly to the power supply.

To connect fans to the Active Air Chimney, first you need to remove the right side panel (seen from the front) and the top cover (see chapter 4.2). Next, connect the fans to connectors labeled the F1, F2 and F3 on the circuit board.

Then put the cover back on the case. As a last step, please connect the cable from the switch of the Active Air Chimney back to the circuit board (see drawing).

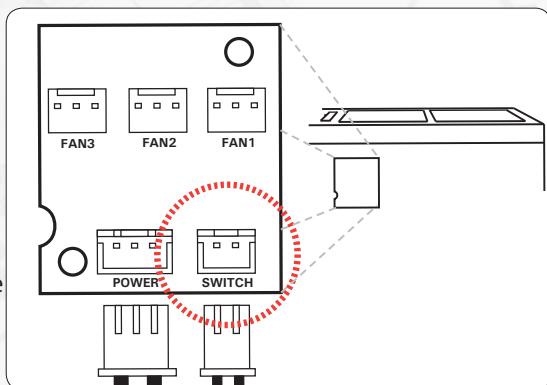



## 7.2 Operation of the Active Air Chimney

In order to open the Air Chimney, slid the dial to the “open” position. This automatically activates the pre-installed case fans under the top cover.

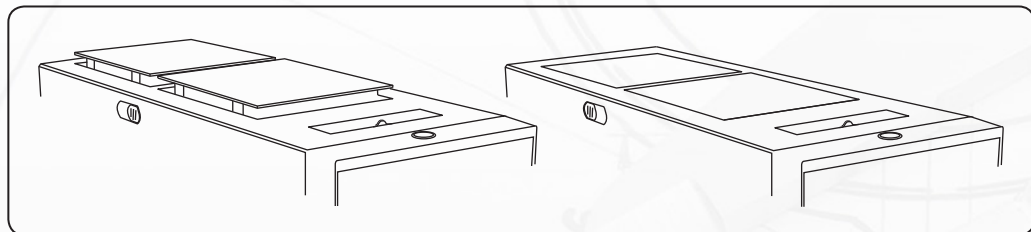

To close the Air Chimney simply slide the tab back in the opposite position. This will also deactivate the fans.

## 8. Installing a water cooling solution

In the Deep Silence Nanoxia 6 Rev. B, you can install both in the specially designed mounting bracket, as well as under the cover radiators or compact water cooling solutions

### 8.1 Installation of a radiator or compact water cooling solution on the mounting bracket behind the HDD-cage

Your new PC-case is equipped with a special mounting bracket that is ideally prepared to receive a 120/140/240/280 mm radiator. It makes it possible to mount a radiator and can be equipped with up to four fans for maximum heat-dissipation. Including the pre-assembled 2 x 140 mm Nanoxia Deep Silence fans behind the front panel, up to 6 fans provide a superior cooling performance.

In order to fix a radiator on the Mounting Bracket, you need to remove it first by removing the four screws, with which the holder is attached to the HDD cage (see chapter 5.3).

Next, set the radiator you would like to install flat on the table. Position the mounting bracket with the outside on the radiator as seen in the picture below.

Put up to two 120 or 140 mm fans into the Mounting Bracket and connect fans, bracket and radiator with extra-long screws.



For maximum cooling capacity of your radiator, you can then mount up to two additional 140 mm or 120 mm fans on top of the radiator.

**If you use a very large radiator, it may be that the hose connectors block the mounting screws of the frame. In this case, please use the special, included thumbscrews to fix the frame to the case.**



## 8.2 Installation of a radiator or compact water cooling under the top cover

For the installation of the radiator under the top cover, please use the offset mounting holes, as shown in the diagrams below. The offset ensures the best possible compatibility with current motherboards, even when using extra thick radiators.

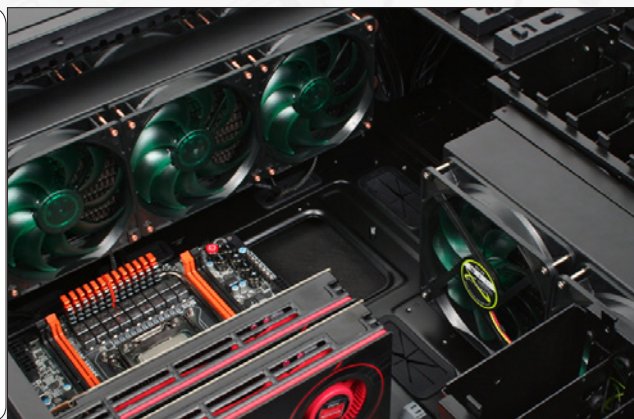
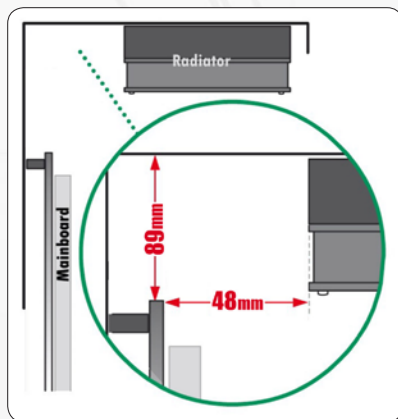

For the installation, remove the top plastic cover (see chapter 4.2) as well as the right side panel (seen from the front) and remove the pre-installed 140 mm fans. Please keep in mind to release the fan cable from the circuit board of active air chimney (see chapter 7.2).

Hold the radiator from the inside to the ceiling and mount it as you see in the picture(s).

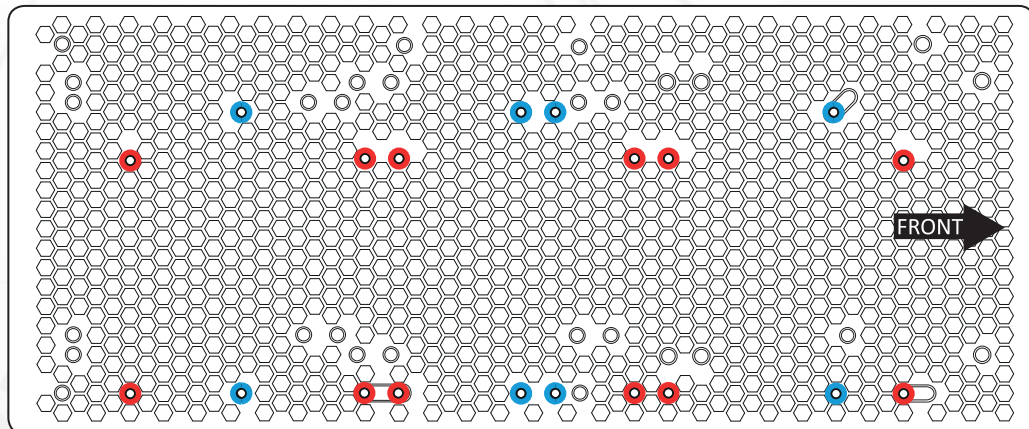

## 9. The I/O-Panel

The I/O panel includes connectors for external USB devices (2 x USB 2.0, 4 x USB 3.0), and the microphone and headphone ports. To protect the connectors against contamination and to ensure a uniform design, the I/O-panel is closed with a sliding lid. In order to open it, firmly push the lid to the rear.

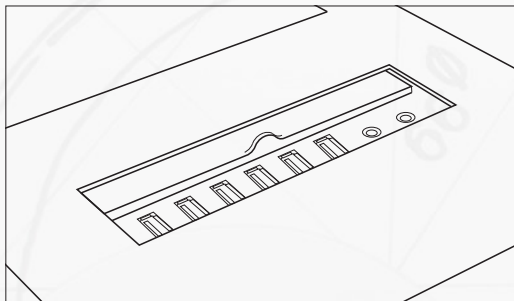

The blue USB connectors are super-Speed USB 3.0, USB 2.0 ports are black. The left audio connector (when viewed from the front) is for headphones, the right is intended for a microphone.

### III. Support

Dear customer,

The PC case you purchased has undergone a very thorough quality control. Nevertheless, should there be any unexpected problems with your case we ask that you first approach the dealer where you purchased the product. They are prepared to assist you with competent and uncomplicated advice and practical support.

If perhaps a few screws were missing or you might have a question that can't be answered by this manual, please do not hesitate to contact us directly by e-mail.

Likewise, we would appreciate your suggestions and comments about our case very much. Our staff will respond to all inquiries quickly and professionally.

**Customers from Germany and other European countries can use the following e-mail address for support questions, spare parts or warranty issues:**

[support@nanoxia-world.com](mailto:support@nanoxia-world.com)

**Customers from Africa, Asia, Australia as well as North and South America can use the following e-mail address for support questions, spare parts or warranty issues:**

[support.overseas@nanoxia-world.com](mailto:support.overseas@nanoxia-world.com)

For general inquiries, comments, suggestions and the like please refer to:

[info@nanoxia-world.com](mailto:info@nanoxia-world.com)

We are sure that you will be satisfied with Nanoxia Deep Silence 6 Rev. B for many years to come, so please enjoy your new PC case.

Your Nanoxia Support-Team



© Nanoxia 2014